

1. Sleeping Mode
2. Brightness setting
3. Backlight color select feature
4. Save setting /Clear peak value
5. Arrow keys
6. Warning value adjustable
7. Warning sound mute feature
8. Peak Recall setting
9. Functions collections

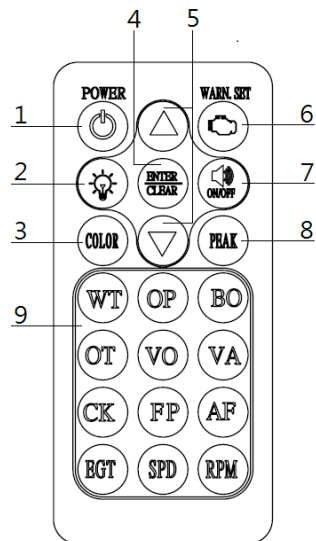

## Instructions

### STEP 1

Choose the functions needed at the functions collections area.

### STEP 2

Once complete the connection between the remote controller & the gauge, then could continue the following settings.

(While the needle light start flashing it means the remote controller & the gauge have been linked)

#### A. Sleeping Mode

Press POWER (1) enter into the Sleeping mode, recover the gauge which is in the Sleeping mode, just need to press POWER (1) again.

#### B. Warning Value Setting

Press WARN.SET (6) for adjusting the warning value, in the meantime the warning light will be flashing, continue press ARROW KEYS (5) to set a suitable warning value, once done it, press ENTER(4) save the value and out of setting, otherwise, wait 5 secs without any operation and could continue other settings.

#### C. Brightness adjustable mode

Press the Brightness adjustable button to set the brightness. In the meantime, the warning light and peak light will start flashing, press ARROW KEYS (5) for setting brighter or dimmer, once done it, Press ENTER (4) for save and out of setting, otherwise, wait 5 secs without any operation and could continue other settings.

#### D. Peak mode

Press PEAK (8) enter the peak value recall mode, the peak value can be displayed.

#### E. For Clear Peak

Press PEAK (8) enter the peak value recall mode, in the meantime, the peak light is keep brightened, then press CLEAR (4) for clear peak, the peak light turn to flash. Once done it, which will automatically go out of the Peak mode.

#### F. LED color switch

Press COLOR (3) for change the backlight color. Total three colors: White, Blue and Amber is optional.

#### G. Sound could be turn on/turn off

Press ON/OFF(7) for setting the sound turned on/ turned off. One Beep sound for muting mode, Two Beep sound is Voice Mode.

### STEP 3

Once done all of the settings, after 10 secs the gauge will leave out the link with the remote controller with any operation.

### Note:

**Not all of the remote-controlled gauge could have the above all settings. Please double check the purchased gauges whether could support above all settings then start program your multifunction gauge.**

## ELECTRICAL GAUGES W/PEAK & WARNING

60mm DX SERIES White / Blue / Amber LED Display

### Fuel Press Gauge

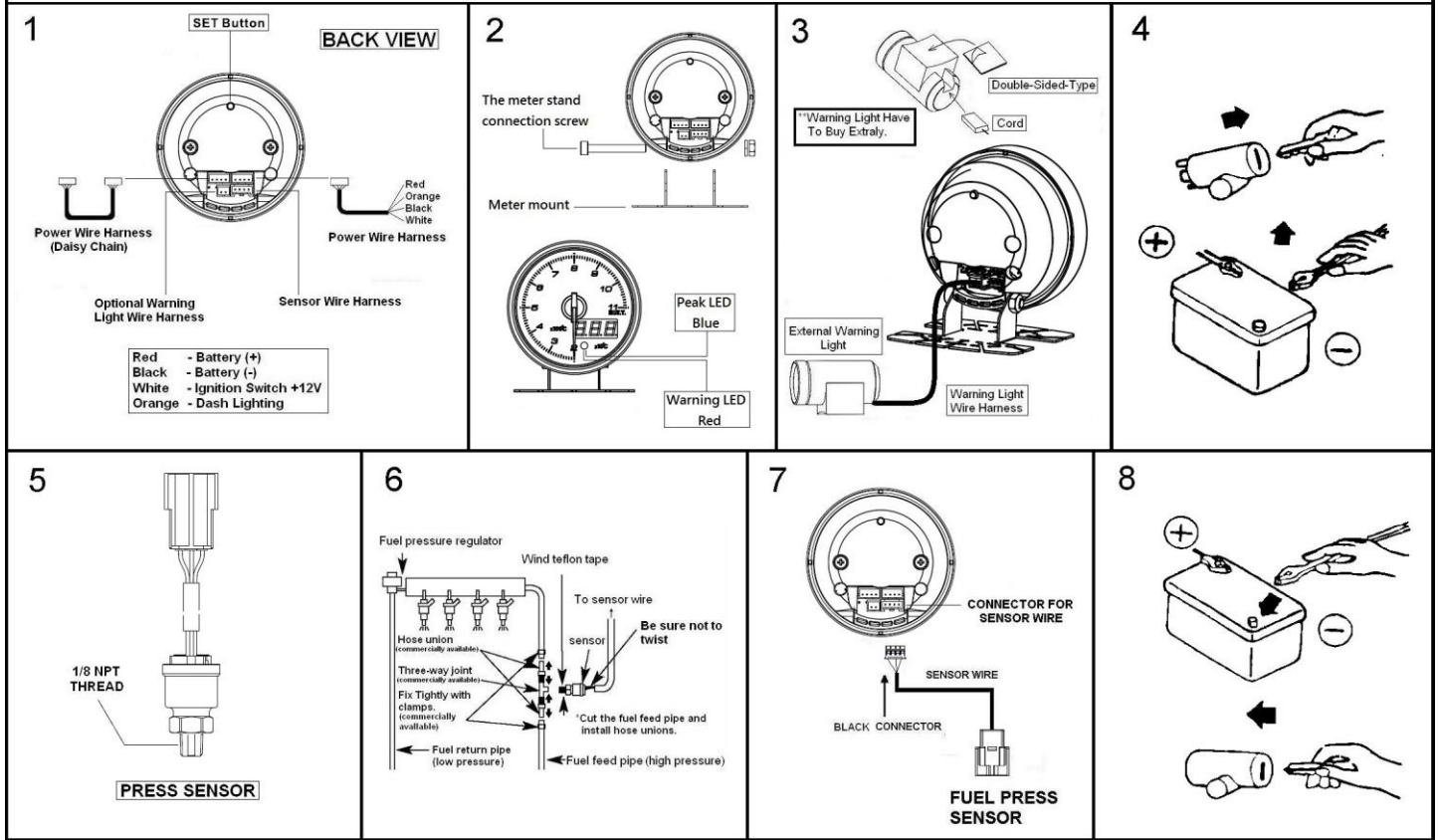

### OPERATING INSTRUCTION

**WARNING: IT IS DANGEROUS TO OPERATE THE SETTING OF THE GAUGE WHEN YOU ARE DRIVING, CONSIDERING YOUR AND OTHERS SAFETY, PLEASE OPERATE THE SETTING BEFORE DRIVING.**

#### Selectable Brightness Levels

Three colors available: Amber / Blue / White. there have six stages of brightness level.

The DX Gauge Series selectable brightness settings for both day and night lighting modes. Below are the instructions on how to program each lighting mode.

#### Day mode

- Press the button located on back of the gauge to adjust backlight.
- Press the button to cycle through the 18 dimming modes.
- Once you selected your ideal setting release the button and the gauge will save your selection.

#### Night mode

- This mode is only available if the orange dimmer wire is connected and your headlights are powered.
- Press the button to cycle through the 18 dimming modes.
- Once you selected your ideal setting release the button and the gauge will save your selection.

#### Peak Mode

- 1.) Hold the button for 3 seconds to enter peak mode and the "PEAK" light will come on. The pointer will rise to the highest level attained by the gauge and remain there approximately 5 seconds.
- 2.) To reset peak level: Hold the button while in peak mode ("PEAK" light is on).
- 3.) The gauge will back to normal mode after 5 seconds inactivity.

#### Warning Settlement

Hold the button for 5 seconds until the pointer begins to blink. Push and hold the button to move across the scale or toggle button to move pointer in small increment. Once you have the pointer you want, then wait 5 seconds and pointer will stop blinking.

#### Mute Feature

- 1.) With ignition key in off position, hold the button – Turn ignition on, wait for pointer to come to a rest then release button.
- 2.) To turn sound on – Repeat step 1.